

# TIVO UPGRADE INSTRUCTIONS (#85)

(c) 2001-2006, weaKnees. All rights reserved.

Instructions for ONE DRIVE REPLACEMENT for most Series 3 HD TiVo DVRs  
These instructions are available in COLOR at <http://www.weaknees.com/upgrade-instructions.php>

## A FEW WORDS OF CAUTION:

Upgrading a TiVo presents a few physical hazards. As with most consumer electronics devices, components in the TiVo may still carry a lethal charge, even after disconnecting from your power supply. Be aware of this while working inside your TiVo. Allow sufficient time for discharging of components and avoid contact as much as possible with potential hazards. While we have done everything we can to provide accurate, easy-to-follow instructions, we cannot be responsible for any damage done to your TiVo or to yourself as a result of your upgrade. By opening your TiVo, you agree that neither weaKnees nor any of its members or affiliates is responsible in any way for any harm done. Please be VERY careful when upgrading. NEVER open the TiVo while the unit is plugged in and NEVER operate the TiVo if the lid is not securely fastened. PLEASE NOTE: Opening the TiVo voids the warranty

### THIS KIT INCLUDES:

- 1 T10 Torx L-Key (see Figure 1)
- 1 T15 Torx L-Key (see Figure 1)
- 1 Upgrade hard drive (not shown)
- 1 Set of upgrade instructions (not shown)



Figure 1

## 1. OPEN THE TIVO

Unplug the power cord from your TiVo and wait five minutes for the TiVo to discharge. Do not plug the TiVo back in until you are completely finished. Be very careful of static electricity, which can destroy your TiVo's internal parts. You should not perform this upgrade on carpet.

Using the Torx T10 (smaller of the two) L-key included with your kit, unscrew the six (6) Torx screws on the back of your TiVo. The screws are surrounded by black from the top of the TiVo's case.

Once the six screws are removed, remove the lid. Place your palms on the top side edges of the TiVo, toward the back and push toward the back of the TiVo (this occasionally requires a bit of force). The cover should slide back and then up. Remove the cover from the TiVo.



Figure 2 (above) Back View



Figure 3 (above) Front View

## 2. DISCONNECT THE EXISTING DRIVE BAY

With the cover off and looking to the front-left of the TiVo, you will be able to see (1) one hard drive, (2) a set of cables (the “drive cable”) running to the back of the hard drive (the drive cable connects to the hard drive with a black connector, and consists of a red cable that carries data, and a multi colored set of cables that carry power), (3) a white clip holding the drive power cable, (4) two black tuner cables running over the hard drive and clipped to the side of the hard drive, and (5) four drive bracket screws that connect the hard drive and its bracket to the TiVo. See Figure 4.

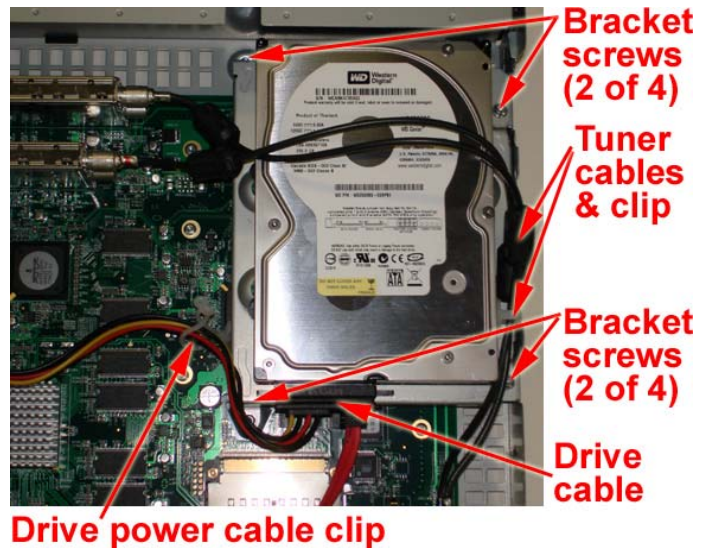

Figure 4 (above) Top View

Gently remove the drive cable from the back of the hard drive. Hold the black connector and pull straight back. Remove the drive power cable from the drive power cable clip. Move the drive cable toward the back of the unit, away from the hard drive and hard drive bracket. See Figure 5.

Gently pull on the clip that holds the tuner cables to the hard drive. In most cases, the tuner cable clip will easily come off the hard drive. If yours does, then keep the tuner cables inside the clip and move the tuner cables and clip, together, away from the hard drive, toward the back of the unit. If your clip is glued tightly to the drive, then simply remove the tuner cables from the clip and move the tuner cables away from the hard drive. If your clip came off easily, it will be re-attached to the replacement drive once the upgrade process is complete. See Figure 5.

Using your Torx T10 L-key, unscrew and remove the four bracket screws that connect the hard drive bracket to the lower bracket (part of the bottom of the unit). Set these bracket screws aside. You will be using them again later. See Figure 4.



Figure 5 (above)

## 3. REMOVE THE EXISTING DRIVE

Take note of the position of the drive that you will be removing from the bracket. You will be installing the new drive onto the bracket in the same direction.

Using your Torx T15 L-key, unscrew the four Torx screws that connect the hard drive to the hard drive bracket. Keep these four drive screws handy; you will re-use them in the next step. See Figure 6.

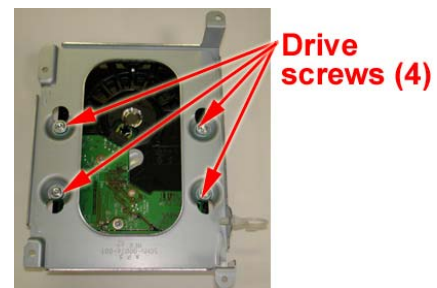

Figure 6

## 4. CONNECT THE NEW HARD DRIVE TO THE DRIVE BRACKET

Orient your new drive and the bracket as shown in Figure 7. The drive label should be face down, and you should be looking at the drive connector. The bracket should have the bracket peg facing up, as shown. See Figure 7.

Once you have the bracket and drive oriented as in the picture, lift the bracket up and place it onto the drive, so that the four colored grommets are over the four screwholes in the drive.



Figure 7

Using the four screws you removed in the previous step, attach the drive bracket to the drive. Do not overtighten the four screws.

## 5. INSTALL THE HARD DRIVE AND BRACKET BACK INTO THE TIVO

Install the drive and bracket into the TiVo so that the bracket's four screwholes are aligned with the four holes in the TiVo. The drive's power and data connectors will face the back of the TiVo. See Figure 8

Secure the bracket to the TiVo using the four bracket screws you removed in Step 2.



Figure 8

## 6. ATTACH THE CABLES

Once the bracket and new drive are installed, attach the drive cable to the hard drive.

Then, insert the drive power cable back into the drive power clip and twist the ends of the clip.

Finally, put the tuner cables back in place. If you were able to remove the tuner cable clip, then attach the tuner cable clip to the side of the hard drive closer to the edge of the TiVo. Be sure that the tuner cables do not hang out over the side of the TiVo. If you were unable to remove the tuner cable clip, place the tuner cables between the drive and the edge of the TiVo. See Figure 9. NOTE: The exact location of the tuner clip on the drive is not important, so long as the tuner cables are not in the way of the lid when you replace it.



Figure 9

## 7. RE-ATTACHING THE TIVO LID

Place the TiVo lid back over the TiVo with the back of the lid overhanging the TiVo by about three-quarters of an inch. At the same time, align the clips on each side of the lid so that they clip down on the sides of your TiVo. As you close the lid, be very careful of the tuner cables, which are situated close to the side of the TiVo. Slide the lid toward you while simultaneously pushing down on the top of the lid. See Figure 10. Once the lid is in place, reattach the six screws. Plug in your TiVo and enjoy!



Figure 10

You can verify your new capacity by looking in the System Information screen of your TiVo. The System Information screen is located in the "Messages and Setup" menu. Once in the System Information screen, you will see "Variable up to XX HD or YY SD hours" (you may have to scroll down the page using the "channel down" button). This message gives you the maximum capacity of your unit, after the upgrade.

NOTE: If after installation of your new hard drive certain channels are not available, you will want to call your cable company and verify that the Host ID and Data ID that they have matches the TiVo's CableCARD settings screen.

We thank you very much for your purchase and hope that you enjoy your newly-enhanced TiVo. Please [email us](#) with any comments, suggestions or complaints. If you found the upgrade easy to install (or even if you found it more difficult than you expected), we'd love to know. If you found our service to be excellent (or awful), we want to know that too. We're always looking to improve our products and services...the more we hear from you, the better. Thanks very much!